

Impression 1000 wide

Artwork spec and file set up guide

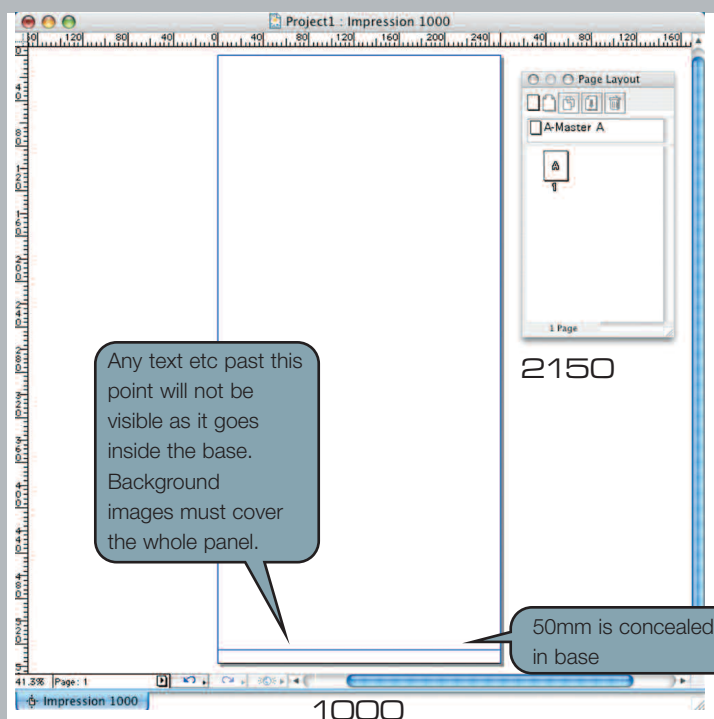

Front Panel main:

1000mm wide
x 2150mm high

visible area 2100 high

Document size 250 x 537.5mm
@ 25%

TIPS:

- Avoid putting text beyond the guides
- Where accurate colour matching is essential you must supply pantone or printed references. We will match as close as possible.

FILE SET UP:

- QuarkXPress or Adobe Indesign are preferred. When using Illustrator, Freehand or Photoshop, import your images into Quark, Indesign.
- Be sure to include all source files, graphics and all fonts with your job.
- All Photoshop images need to be 350dpi. The greater the dpi the better results you will achieve.
- Save all images as EPS's or Tiff's in Photoshop, and convert all duotones and RGB images into CMYK.
- All corporate logo's must be vector files, i.e created in Illustrator and Freehand and set Attributes to 2000 dpi.
- Graphic work needs to be Apple Mac format and not PC. We require Artwork on CD or sent via email. Please include proof copy or pdf of artwork with the disc or email. If sending via email please send it direct to our graphic department, the address you need is : jason@displaymatrix.co.uk

To send disk and proof address it to



Display Matrix Limited, Olympia House, 196 Broomhill Road,
Brislington, Bristol, BS4 5RA

Tel: 0117 977 2278 | Fax: 0117 977 2457 | info@displaymatrix.co.uk